

CAX 4100 TN - GN1/1

Tavolo refrigerato quattro ante ventilato
Temperatura normale
Ventilated four door refrigerated counter
Positive temperature



CAX 4100 BT

Tavolo refrigerato quattro ante ventilato
Bassa temperatura
Four doors ventilated refrigerated counter
Negative temperature

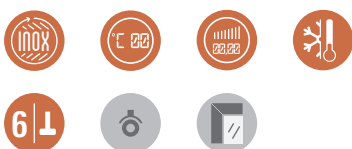

ALTRE CONFIGURAZIONI DISPONIBILI

CAX 4100 TNG / CAX 4100 BTG Versione con porte in vetro e led interno
With glass doors and inner led lighting

CAX 4110 TN Versione con 1 Cassettera refrigerata da N.2 Cassetti da 1/2
1 refrigerated room with 2 1/2 drawers

CAX 4120 TN Versione con 1 Cassettera refrigerata da N.2 Cassetti (1 da 1/3 + 1 da 2/3)
1 refrigerated room with 1 1/3 + 1 2/3 drawers

CAX 4130 TN Versione con 1 Cassettera refrigerata da N.3 Cassetti da 1/3
1 refrigerated room with 3 1/3 drawers

CAX 4140 TN Versione con 2 Cassettiere refrigerate da N.2 Cassetti da 1/2
2 refrigerated doors with 2 1/2 drawers

CAX 4150 TN Versione con 2 Cassettiere refrigerate da N.3 Cassetti da 1/3
2 refrigerated doors with 3 1/3 drawers



CAX 4200 TN - CON ALZATINA

Tavolo refrigerato quattro ante
ventilato con alzatina
Temperatura normale
Ventilated four door refrigerated counter
with splashback
Positive temperature

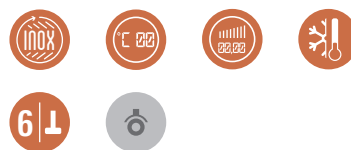

Maniglia integrata
Built-in handle



Mensole a scorrimento
Sliding shelves



Versione TNG con porte in vetro - **Optional**
TNG version with glass doors - **Optional**



Caratteristiche / Features

Modello / Model	CAX 4100 TN - GN1/1	CAX 4100 BT	CAX 4200 TN con alzatina with splashback
Temperatura / Temperature Range	-2 °C / +8 °C	-10 °C / -20 °C	-2 °C / +8 °C
Classe Climatica / Climate Class	4	4	4
Volume Netto-Lordo / Net-Gross Volume	Lt. 412 / 616	Lt. 412 / 616	Lt. 412 / 616
Superficie Esterna / Body	Acciaio Inox / Stainless steel	Acciaio Inox / Stainless steel	Acciaio Inox / Stainless steel
Superficie Interna / Inner Liner	Acciaio Inox / Stainless steel	Acciaio Inox / Stainless steel	Acciaio Inox / Stainless steel
Termometro / Thermometer	Digitale / Digital	Digitale / Digital	Digitale / Digital
Regolatore temperatura / Controller	Elettronico / Electronic	Elettronico / Electronic	Elettronico / Electronic
Spessore isolamento / Insulation thickness	mm 60	m 60	mm 60
Sbrinamento / Defrost	Automatico a fermo compressore + Manuale Automatic compressor cycle + Manual	Automatico con resistenza elettrica + Manuale Automatic with electric heater + Manual	Automatico a fermo compressore + Manuale Automatic compressor cycle + Manual
Mensole (LxP) / Shelves (WxD)	N° 4 - mm 330 x 530	N° 4 - mm 330 x 530	N° 4 - mm 330 x 530
Altezza Alzatina / Splashback Height	-	-	mm 110
Piedi-Ruote / Feet-Rollers	6 Piedi / 6 Feet	6 Piedi / 6 Feet	6 Piedi / 6 Feet
Ruote / Rollers	Optional	Optional	Optional
Versione con porte in vetro e led interno With glass doors and inner led lighting	Optional	Optional	-
Combinazione con cassetti refrigerati - Optional Combination with refrigerated drawers - Optional	Optional N°2 GN1/2 N°3 GN1/3 N°1 GN1/3 + N°1 GN2/3	Optional N°2 GN1/2 N°3 GN1/3 N°1 GN1/3 + N°1 GN2/3	Optional N°2 GN1/2 N°3 GN1/3 N°1 GN1/3 + N°1 GN2/3
Peso Netto-Lordo / Net-Gross Weight	Kg 138 / 158	Kg 146 / 166	Kg 152 / 172
Voltaggio / Voltage	V 230	V 230	V 230
Frequenza / Frequency	Hz 50	Hz 50	Hz 50
Refrigerante / Refrigerant	R290	R290	R290
Absorbimento / Absorption	W 230	W 670	W 230
Consumo Energia / Energy Consumption	KwH/24H 3,59	KwH/24H 14,98	KwH/24H 3,59

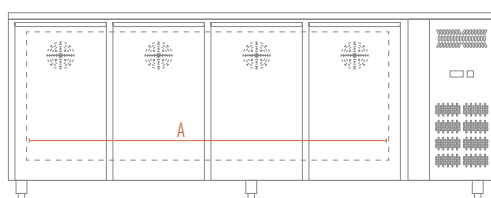
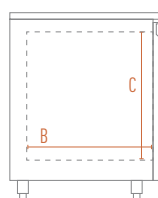
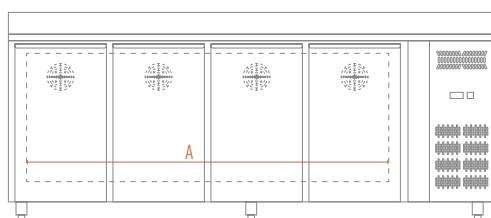
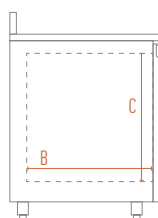
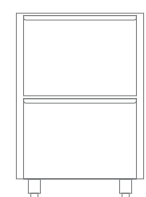
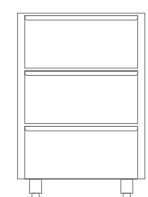
 CAX 4100 TN/TNG/BT
FRONTE / FRONT

 CAX 4100 TN/TNG/BT
LATO / SIDE

 CAX 4200 TN CON ALZATINA / WITH SPLASHBACK
FRONTE / FRONT

 CAX 4200 TN
CON ALZATINA/ WITH SPLASHBACK
LATO / SIDE

 CASSETTIERA
2 CASSETTI da 1/2
REFRIGERATED
ROOM WITH 2 1/2
DRAWERS

 CASSETTIERA
3 CASSETTI da 1/3
REFRIGERATED
ROOM WITH 3 1/3
DRAWERS

Dimensioni mm / Dimensions mm

Modello / Model	CAX 4100 TN/TNG - GN1/1	CAX 4100 BT	CAX 4200 TN con alzatina with splashback
Dimensioni Esterne (LxPxH) / External Dimensions (WxDxH)	2230 x 700 x 860	2230 x 700 x 860	2230 x 700 x 960
Dimensioni Imballo (LxPxH) / Packaging Dimensions (WxDxH)	2260 x 740 x 910	2260 x 740 x 910	2260 x 740 x 1010

Dimensioni Interne mm / Inner Dimensions mm

A - Larghezza / Width	1663	1663	1663
B - Profondità / Depth	580	580	580
C - Altezza / Height	589	589	589